



CoaguChek® Vantus System

Quick Reference Guide



1

Read this first

This guide helps you to set up your system for the first time as well as to prepare and perform a test. It does not replace the CoaguChek Vantus User's Manual. The User's Manual contains important handling instructions and additional information, including how to use the *Bluetooth*® functionality.¹

Overview

- A Display
- B Back button ←
- C Up/down arrows button ▲▼
- D Enter button (Power on) ■
- E Test strip guide cover
- F Test strip guide
- G Battery compartment cover
- H Code chip slot
- I USB port
- J Test strip container
- K Code chip

2

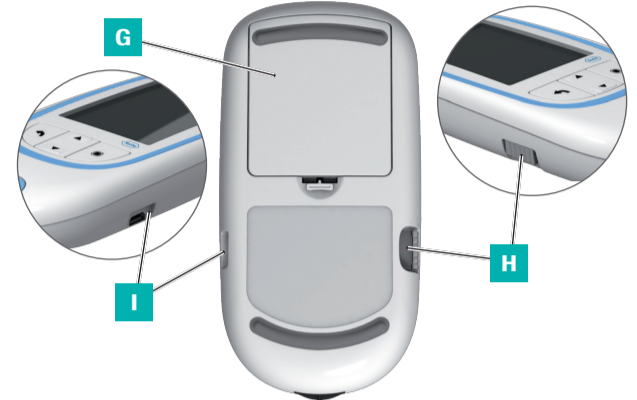

3

Inserting the batteries

- 1 Turn the meter over.
- 2 Gently press the tab on the battery compartment cover towards the top of the meter and lift off the cover.
- 3 Insert the four batteries into the battery compartment as indicated. Pay attention to the positions of “+” (top of battery) and “-” (flat end).
- 4 Re-attach the cover. Close the battery compartment by pushing the cover down until the tab snaps into place.



4



Inserting the code chip

- 5 Slide the code chip, contained in each box of test strips, into the slot on the left side of the meter as shown until you feel it snap into place.

Powering on the meter

- 6 Press the Enter button ■ to power the meter on.



5



Initial setup

When you power on the meter for the very first time, the meter automatically displays the **Language** screen. A green dot indicates which language is currently active.

- 7 Use the up/down arrows button ▲▼ to select your preferred language. The newly selected language is highlighted (blue).
- 8 Press the Enter button ■ to confirm the selection, which is now indicated by the green dot.
- 9 Press the Enter button ■ again to save the selected language.

6

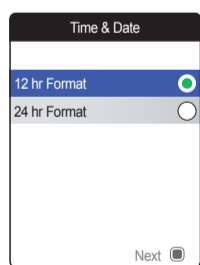

The meter now displays the screen for setting the time format.

- 10 Use the up/down arrows button ▲▼ to select the time format for the display (24 hour or 12 hour am/pm). The newly selected format is highlighted (blue).
- 11 Press the Enter button ■ to confirm the selection, which is now indicated by the green dot.
- 12 Press the Enter button ■ again to save the setting. The screen for setting time and date follows next.

7

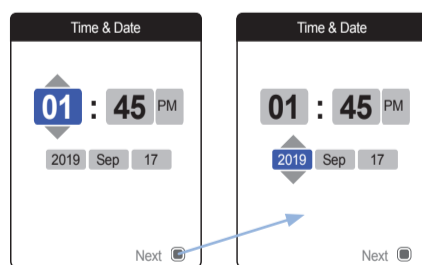

- 13 Use the up/down arrows button ▲▼ to set the current hour.
- 14 Press the Enter button ■ to confirm the hour. The next input field (minutes) will be highlighted.
- 15 Proceed with setting the remaining fields (year, month, day). The Enter button ■ always confirms a setting (and highlights the subsequent field, if available), the Back button ← allows you to go back to the previous field.

8

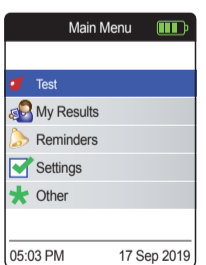

The initial setup is now finished, the meter displays the **Main Menu**. For a complete overview of setup options (including those which are not part of the initial setup) see the User's Manual.

You are now ready to perform a test.

¹ The *Bluetooth*® word mark and logos are registered trademarks owned by Bluetooth SIG, Inc., and any use of such marks by Roche Diagnostics is under license.

9

How to perform a test

Preparing the lancing device

- 1 Remove the cap by pulling it straight off.
- 2 Insert a new lancet. Push it in until it clicks into place.
- 3 Remove the protective cap from the lancet with a twisting motion.

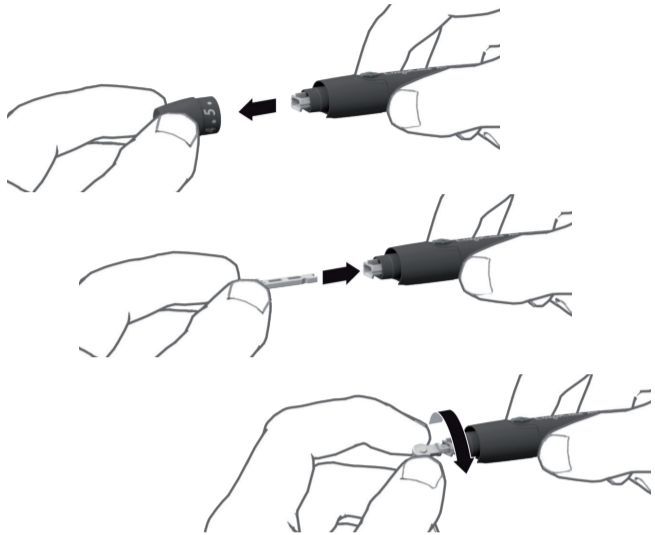

10

- 4 Place the cap back on again until it clicks. Rotate the cap to set the desired penetration depth.
- 5 Press the priming button until it clicks.

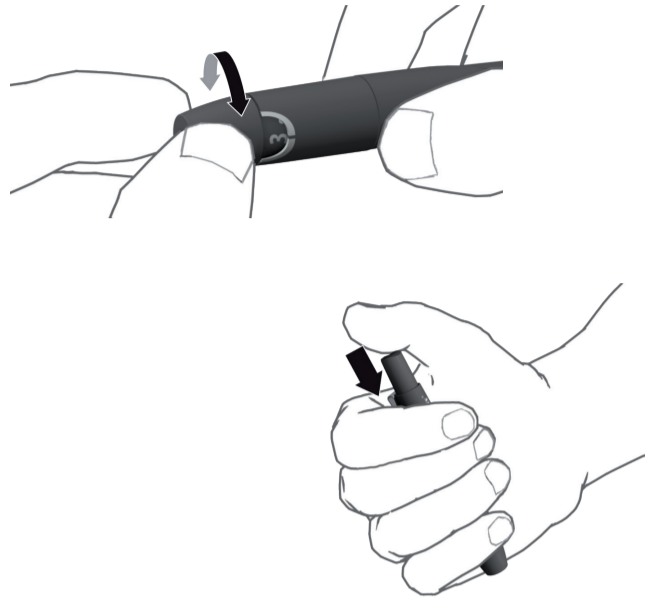

12



The test strip symbol prompts you to insert a test strip.

- 5 Remove a test strip from its container. Immediately after removing a test strip, close the container again with the stopper.
- 6 Hold the test strip so the lettering, the arrows, and the blood drop symbols are facing upward.
- 7 Slide the test strip into the test strip guide in the direction indicated by the arrows. Slide the test strip in as far as it will go. A beep tone indicates that the test strip has been detected (unless you have disabled the beeper function).

13

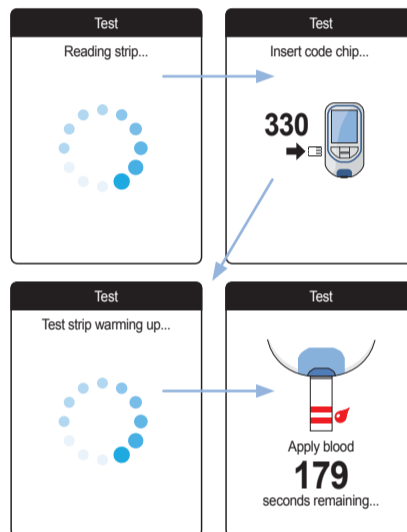

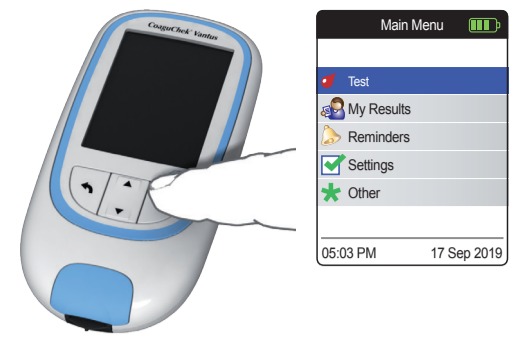

- If you have not inserted the code chip yet, or if it does not match the inserted strip, you will be prompted to insert the correct code chip.
- When the test strip check has been completed successfully, the meter indicates that the test strip is warming up.
- Once the warming-up process is complete, the meter beeps (unless you have disabled the beeper function) and displays the test strip and blood drop symbols. The meter is ready to perform the test, you have 180 seconds to apply blood to the test strip.

11



Performing a test

- 1 Wash your hands with soap and warm water. Dry them thoroughly.
- 2 Place the meter on a level, vibration-free surface or hold it in your hand so it is roughly horizontal.
- 3 Power the meter on by pressing the Enter button .
- 4 After startup, **Test** is preselected and highlighted. Press the Enter button  to start the test.

Alternatively, you can insert a test strip to power it on, which will put the meter – after completing the startup – into test mode directly.

14

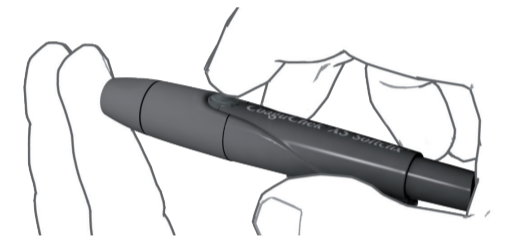

- 8 Now lance the side of a fingertip with the lancing device by pressing the yellow release button.
 - 9 Massage the lanced finger until a drop of blood is formed.
- CAUTION: Do not press or squeeze the finger.**
- 10 Apply the **first drop of blood** directly from the finger to the semicircular, transparent sample application area of the test strip.
- CAUTION: Apply the blood drop to the test strip within 15 seconds** of lancing the fingertip. Applying blood after this period of time would falsify the result, as the coagulation process would already have begun.



15

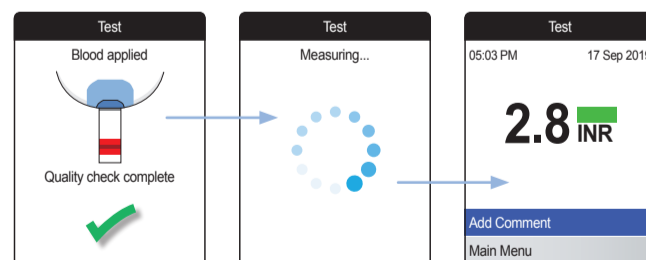

A beep tone indicates that you have applied enough blood (unless you have disabled the beeper function).

















The meter now performs an automatic quality control check and starts the coagulation measurement.

The result is displayed and automatically saved to memory.

The test is now completed.

16

Icons on the display

Symbol	Meaning	Symbol	Meaning
	Battery capacity		Appointment icon
	Bluetooth logo (wireless data transfer)		Comment icon
	USB symbol (wired data transfer)		Upload icon
	Test icon		Radio button (off/on)
	My Results icon		Warning message
	Reminder icon		Error message
	Settings icon, selected option		Maintenance message
	Other icon		Information message
	Medication icon		



COAGUCHEK, COAGUCHEK VANTUS, and SOFTCLIX are trademarks of Roche.

©2018-2019 Roche Diagnostics GmbH

Roche Diagnostics GmbH
Sandhofer Strasse 116
68305 Mannheim, Germany

www.coaguheck-usa.com
https://diagnostics.roche.com
www.roche.com

Manufactured for and distributed
in the U.S.A. by:
Roche Diagnostics
9115 Hague Road
Indianapolis, IN 46256

Rx only

OS-00426-02
0 746 098001 (03) 2019-08 EN USA